

LEGEND

- Proposed Grass (Rear Gardens)**  
To be seeded
- Proposed Grass (Front Gardens & POS)**  
To be laid with turf
- Proposed Ornamental Planting**  
Mixed shrub and herbaceous planting  
5-7ltr pots with 10ltr specimens  
Planting beds to receive 75mm depth ornamental bark mulch.
- Proposed Native Buffer Planting**  
Understorey shrubs to be 60-90cm height in groups of 3 or 5 protected by tubex or spiral guard
- Proposed Formal Hedge**  
To be planted at 60-80cm container stock at 3 per lin.m
- Proposed Deciduous Tree (Single Stem)**  
Extra Heavy Standard trees, 16-18cm girth, 4.5-5m high to be planted with a double-timber stake secured with a rubber tree tie.
- Proposed Deciduous Tree (Multi-Stem)**  
Multi-stem trees, 10-12cm girth, 3-3.5m high to be planted with a double-timber stake secured to several branches with rubber tree ties.
- Proposed Deciduous Tree (Native)**  
Select Standard trees, 10-12cm girth, 3-3.5m high to be planted with a double-timber stake secured with a rubber tree tie.

PLAN 1

PLAN 2

Planting Schedule (Individual)										
Herbaceous										
Nr	Code	Plant Name	Height/Spread/Grade	Girth	Age	Root	Container	Habit	Form	Density/m2
5	Bc	Bergenia cordifolia	20-25cm			C	5L			3.00
Shrub										
Nr	Code	Plant Name	Height/Spread/Grade	Girth	Age	Root	Container	Habit	Form	Density/m2
14	CIS	Choisya ternata 'Sundance'	30-40cm			C	5L	Bushy		3.00
36	ELEG	Euonymus fortunei 'Emerald 'n' Gold'	20-25cm			C	5L	Bushy		3.00
41	FMP	Fuchsia 'Mrs Papple'	30-40cm			C	5L	Bushy		3.00
6	HoRE	Hebe albicans 'Red Edge'	40-60cm			C	3L			4.00
8	HoRE	Hebe albicans 'Red Edge'	40-60cm			C	3L			5.00
29	HWG	Hebe 'White Gem'	30-40cm			C	5L	Bushy		3.00
4	HxM	Hypericum x moserianum	5L			C	30-40cm	Bushy		3.00
5	LaH	Lavandula angustifolia 'Hidcote'	30-40cm			C	3L	Bushy		4.00
53	LaH	Lavandula angustifolia 'Hidcote'	30-40cm			C	5L	Bushy		3.00
10	Lnc pl	Lonicera pileata	30-40cm			C	5L	Bushy		3.00
37	PIAb	Potentilla fruticosa 'Abbotswood'	30-40cm(D)			C	5L	Bushy		3.00
126	PL (H)	Prunus lusitanica (hedge)	60-80cm			C	5L	Bushy		3.00
6	PRR	Photinia x fraseri 'Red Robin'	60-80cm		1/1	C	5L			3.00/lin. m
3	PSR	Pyracantha 'Saphyr Red'	60-80cm			C	3L	Leader and laterals		
2	PIBB	Phormium tenax 'Bronze Baby'	60-80cm		2x	C	10-15L			
12	Sh	Sarcococca humilis	20-25cm			C	5L			4.00
4	SjG	Spiraea japonica 'Goldflame'	30-40cm			C	5L	Bushy		3.00
24	SjN	Skimmia japonica 'Nymans'	30-40cm		0/1	C	5L			3.00
20	Sk KG	Skimmia confusa 'Kew Green'	30-40cm			C	3L	Bushy		4.00
12	Src cn	Sarcococca confusa	20-25cm			C	3L	Bushy		4.00
Tree										
Nr	Code	Plant Name	Height/Spread/Grade	Girth	Age	Root	Container	Habit	Form	Density/m2
2	Buj	Beuhia utilis jacquemontii	400-500cm	16-180cm	3x	RB			Extra Heavy Standard	
4	SaA	Sorbus aucuparia 'Asplenifolia'	450-500cm	16-18cm		RB			Standard	

Planting Schedule - Mixes											
Native Shrub Mix											
Nr	Code	Plant Name	Mix%	Height/Spread/Grade	Girth	Age	Root	Container	Habit	Form	Density/m2
6	Cor sa	Cornus sanguinea	25.00 %	60-90cm			B				3.00
10	Crtg mn	Crataegus monogyna	40.00 %	60-90cm		1+0	B			Seedling	3.00
4	Il aq	Ilex aquifolium	15.00 %	60-90cm			BR		Leader with laterals		3.00
2	Prns sp	Prunus spinosa	10.00 %	60-90cm		1+1	B		Branched		3.00
5	Vb op	Viburnum opulus	20.00 %	60-90cm		1+1	B		Branched		3.00
Shrub Mix A											
Nr	Code	Plant Name	Mix%	Height/Spread/Grade	Girth	Age	Root	Container	Habit	Form	Density/m2
44	Eu f EG	Euonymus fortunei 'Emerald Galety'	33.33 %	30-40cm			C	5L			4.00
44	He RE	Hebe 'Red Edge'	33.33 %	30-40cm			C	5L			4.00
12	Lvn an H	Lavandula angustifolia 'Hidcote'	33.33 %	30-40cm			C	3L	Bushy		4.00
32	Lvn an H	Lavandula angustifolia 'Hidcote'	33.33 %	30-40cm			C	5L	Bushy		4.00
Shrub Mix B											
Nr	Code	Plant Name	Mix%	Height/Spread/Grade	Girth	Age	Root	Container	Habit	Form	Density/m2
22	Ce t r	Ceanothus thyrsiflorus var. repens	25.00 %	30-40cm			C	5L			4.00
22	Ch AP	Choisya 'Aztec Pearl'	25.00 %	20-30cm			C	5L	Bushy		4.00
22	Sar co	Sarcococca confusa	25.00 %	30-40cm			C	5L	Bushy		4.00
22	Vb t EP	Viburnum tinus 'Eve Price'	25.00 %	20-30cm			C	5L	Bushy		4.00

NOTES ON PLANTING

- Topsoil:** Topsoil shall be spread to min 450mm depth over planting beds and 150mm depth over turf areas and graded to fall. Topsoil should be in accordance with BS3882:2015 and where subsoil is required, to be in line with BS8601:2013.
  - Herbicide and Cultivation:** Topsoil to be treated with an application of herbicide prior to planting, where necessary, strictly in accordance with the Control of Pesticides Regulations 1986 (or otherwise updated/superseded legislation), and following manufacturer's instructions by qualified staff. The topsoil shall then be cultivated to 150mm depth.
  - Container Grown Shrubs:** Shrubs shall comply with the National Plant Specification. Shrubs shall be planted in pits 300 x 300 x 200mm depth, and the backfill shall include 3 litres Peat Free Tree and Shrub Compost. Specimen plants to be planted in a pit 400 x 400 x 250mm depth with 5 litres Tree and Shrub Compost.
  - Herbicide:** Spot treat with herbicide throughout the maintenance period in accordance with the manufacturer's instructions.
  - Bark Mulch:** All Ornamental Planting beds to receive 75mm depth pulverised ornamental bark mulch.
  - Position of Plants:** Final position of trees and shrubs subject to confirmation of service location and approval of statutory undertakers.
- TREES - EXTRA HEAVY STANDARDS Tree pits for extra heavy standards to be 900 x 900 x 900mm with 300mm of good quality topsoil and backfilled with sub soil. Stakes to be 65mm diameter treated softwood driven firmly into the ground. Stakes to be 600mm above ground level and fixed to tree with suitable rubber tree tie.

- Watering:** Plant only into moist soil and water thoroughly to the full depth of soil immediately after planting. Water regularly through the establishment period (minimum 3 months) to prevent dehydration. The trees should be watered through the irrigation pipe to ensure that the water gets down to the rootball. These trees should be watered regularly throughout spring/summer during the first 2 years to ensure that the tree root system establish well.
- Grass Seeding:** Sow late summer to mid autumn. Prepare ground by removing any existing vegetation, large stones and roughly levelling. Grass seed should be spread at 50g per sq. m. After sowing, lightly rake over area and water.
- Turf:** Complete ground preparations before turf is delivered to site to avoid turf drying out. Turf should be laid immediately on delivery. Remove all existing vegetation from area to be turfed and spread 150mm depth of top soil. Dig over or rotavate soil before laying turf if soil is compacted. Rake, lightly compact, and water soil. Stagger the joints when laying the turf. Water turf after laying and every day for the next 2-3 days, especially in periods of low rainfall.
- Soil compaction** is likely to have occurred during construction on site. A site inspection should be carried out by a landscape professional to assess the level of soil compaction, including drainage testing to see if the ground is likely to become waterlogged. If the ground is deemed to be too compacted for plant growth and to drain adequately then remediation works should be carried out. This could include rotavation of the soil using a push along rotavator and/or ground being broken up with spades or small machinery. A second site inspection should then take place to ensure that the soil is fit for purpose.

LOCATION PLAN

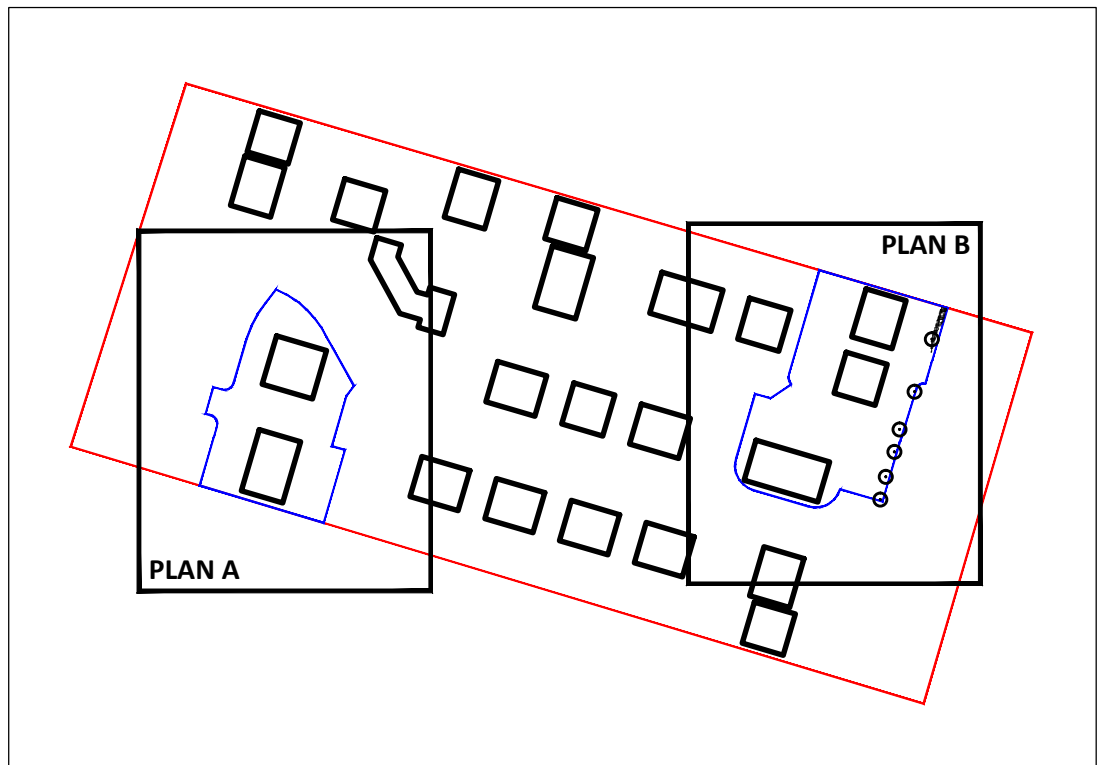

PHASE 1:

Refer to Planting Plan ref. 3448 201 and 3448 202

REVISION NOTES

Rev	By	Description	Date
B	EG	Updated in line with new layout	22.05.20
A	DC	Updated in line with architect comments	11.09.19

Client

Longhurst Group Limited

Project

Crease Drive, Peterborough

Description

Planting Plan (Phase 2)

Status

For Approval

Scale @ A1	Drawn	Checked	Date
1:250	KD	DC	09.09.19
Job number	Drawing number		Revision
3448	203		B

**tpm landscape**  
chartered landscape architects  
address: 4th Floor Studio 10 Little Lever St Manchester M1 1HR  
tel: 0161 235 0600 fax 0601 email info@tpmlandscape.co.uk