

Section A-A
Scale: 1:100
metres

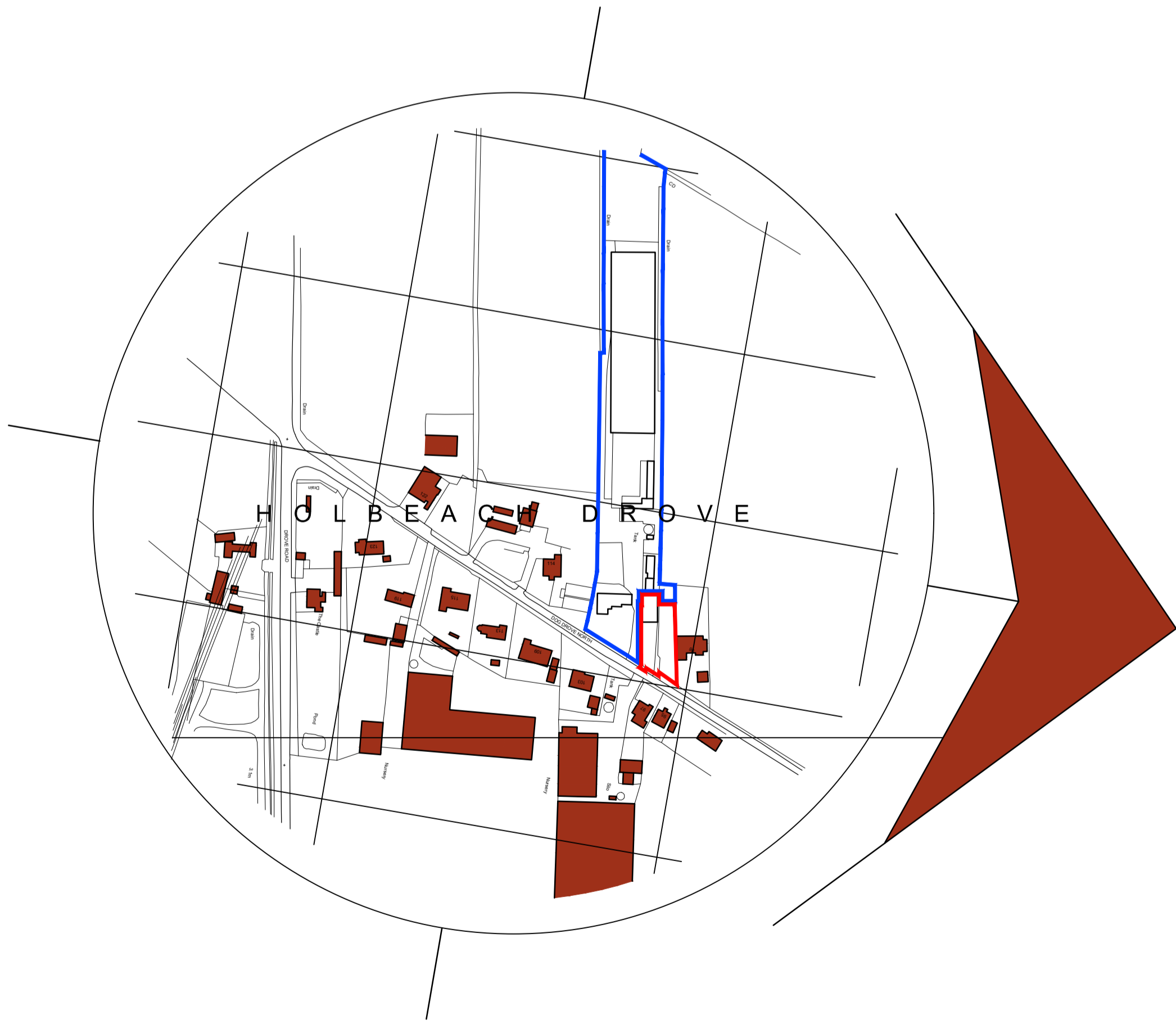

Location Plan
Scale: 1:2500
metres

Landscaping Description	
<p>Trees to include</p> <ul style="list-style-type: none"> Prunus (Flowering Cherry) 'Accolade' Field Maple (Acer campestre) Mountain Ash (Sorbus aucuparia) Whitebeam (Sorbus aria majestica) Size 10-12cm planted. 	<p>Hedge Planting to include:</p> <ul style="list-style-type: none"> Blackthorn Prunus Spinosa, Wild Cherry Prunus Avium, Elder Sambucus Nigra, Dogwood Cornus Sanguinea, Hawthorn Crataegus Monogyna & Holly Ilex Aquifolium C3 pot size, planting size 30cm, planting to be species clusters of 3 or 5 at random intervals along hedge for all species.

- Landscaping Notes** - All planting, seeding or turfing as shown on the above landscaping plan are to be carried out in the first planting and seeding seasons following the occupation of the dwelling on the completion of the development, whichever is sooner; and any trees or plants which within a period of 5 years from the completion date, are to be removed and replaced with others of a similar size and species, unless the Local Planning Authority gives written consent to any variation.
- Method statement for protection of trees on site during construction**
- Prior to the commencement of any construction work on site, protective fencing shall be erected around each tree or tree group. Protective fencing in accordance with above table and BS 5837 unless otherwise agreed in writing with the local Planning Authority. Please see protected areas marked on proposed site plan.
 - No trenches or pipe runs for services and drains shall be sited within 4m of the trunk of any trees retained on the site, unless otherwise agreed in writing with the local Planning Authority.
 - New hard surfaces or paths in accordance with minimum recommended distances for protective fencing.
 - No burning shall take place in a position where the flames could extend to within 5m of foliage, branches or the trunk of any tree to be retained.
- Method statement for nature conservation**
- The existing remaining trees on site are to be protected as above for the duration of the construction to safeguard the habitats of any nesting birds that may be present.

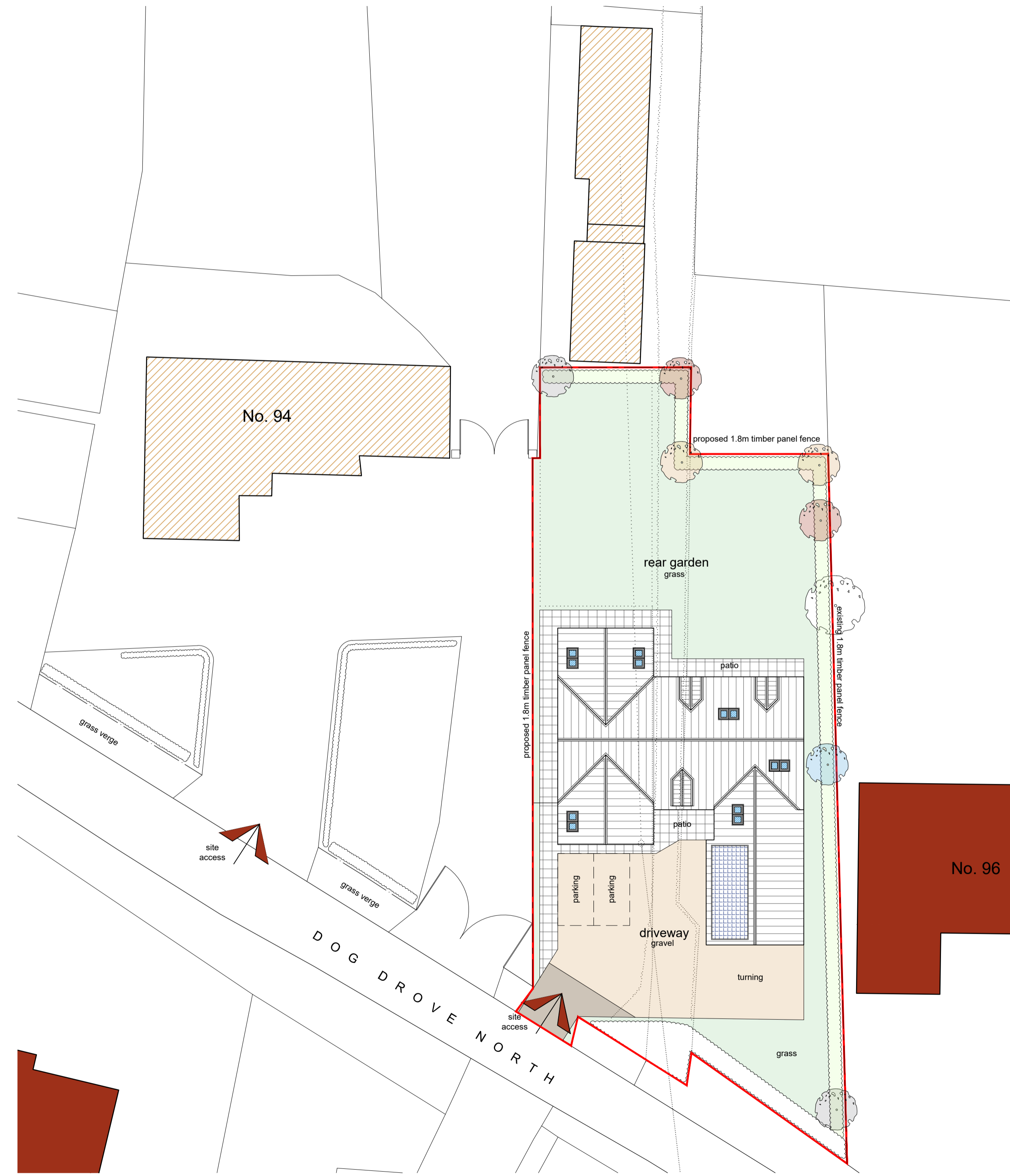

Site Plan
Scale: 1:200
metres

- General Notes**
- All dimensions are shown in 'mm' unless otherwise stated.
 - The contractor, sub-contractors and suppliers must verify all dimensions on site prior to the commencement of any work.
 - This drawing is to be read in conjunction with all relevant engineers and specialist sub-contractors drawings and specifications.
 - Any discrepancies are to be brought to the designers attention.

SITE PLAN KEY

- Indicates existing buildings taken from OS Map
- Indicates existing un-surveyed buildings within applicant's ownership
- Indicates proposed dwelling
- Indicates indicative location of proposed PV panels if required
- Indicates existing features to be demolished
- Indicates proposed grassed areas
- Indicates proposed patio areas
- Indicates proposed gravel driveway
- Indicates proposed hardstanding for first 2m of proposed access in accordance with county council highway's standards
- Indicates proposed site access in accordance with county council highway's standards
- Indicates approximate position of existing soft landscaping on site to be retained
- Indicates proposed soft landscaping

Revisions

A	Dec 2024	Blue Ownership Boundary Expanded
---	----------	----------------------------------

Status: **FOR APPROVAL**

SWANN EDWARDS ARCHITECTURE

Swann Edwards Architecture Limited, Black Barn, Fen Road, Guyhirn, Wisbech, Cambs. PE13 4AA
t 01945 450694 e info@swannedwards.co.uk w www.swannedwards.co.uk

Job Title Proposed Chalet Bungalow at 98 Dog Drove North, Holbeach Drive, Spalding For: Ms C Holmes	Date November 2024	Drawn by GT
Drawing Title Planning Drawing Location Plan, Site Plan & Section A-A	Job No. SE-2185	Sheet Size A1
	Dwg No. PP1000	Revision A