

EXISTING SITE PLAN 1:500

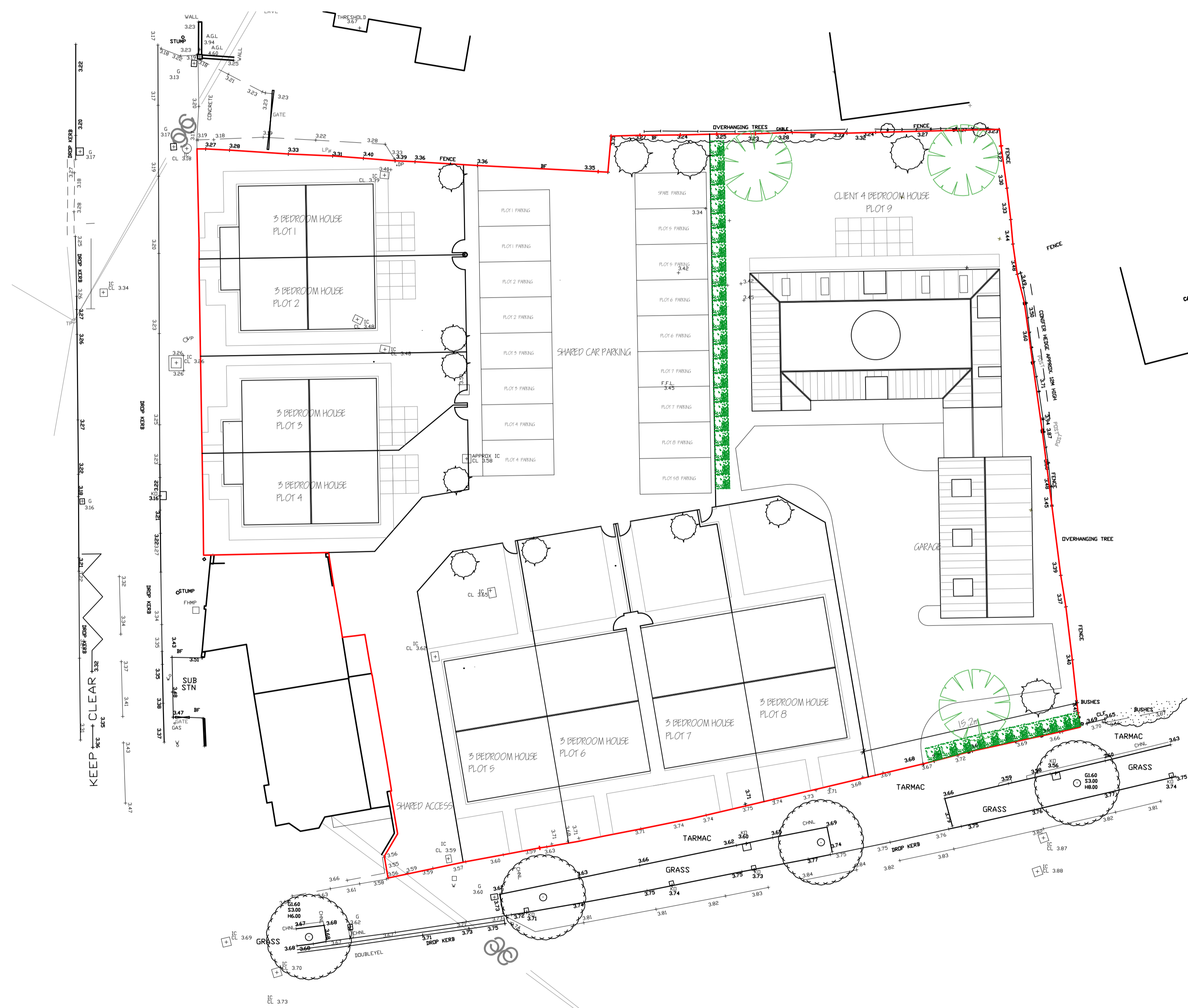

PROPOSED SITE PLAN 1:200

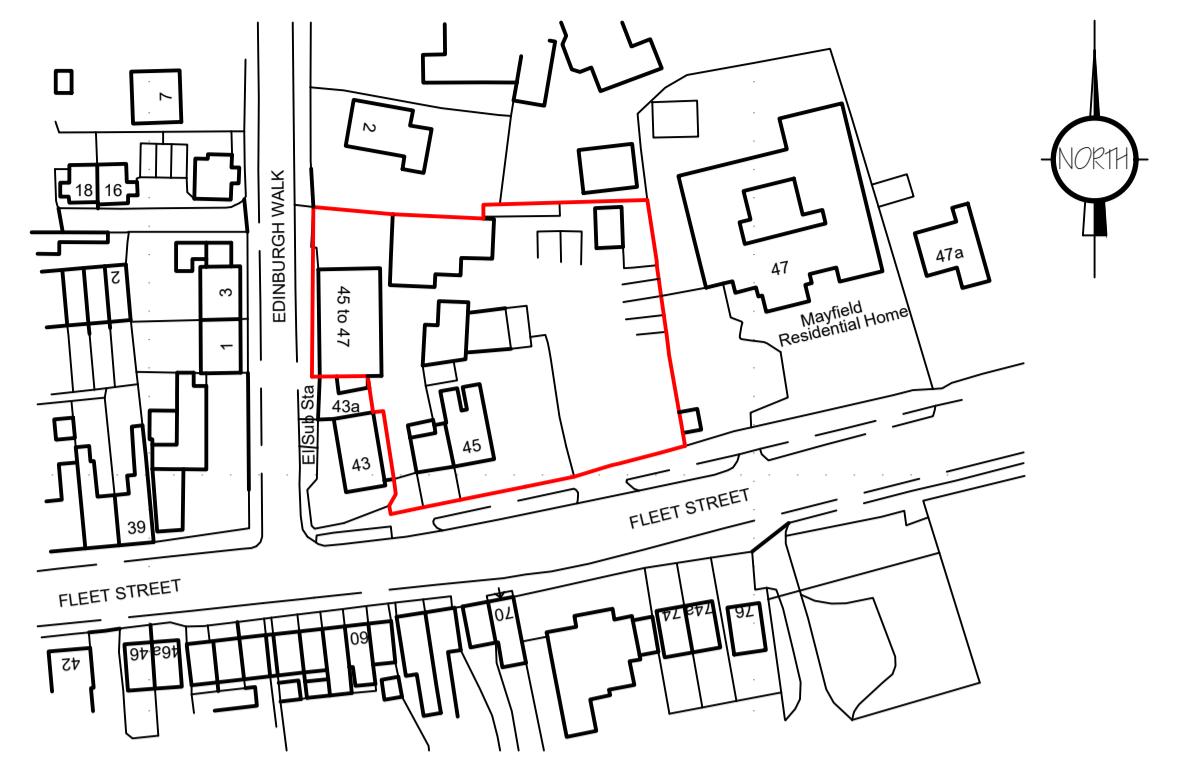

LOCATION PLAN 1:250

NOTE :-
NEW ACCESS TO BE IN ACCORDANCE WITH LCC
HIGHWAYS SPECIFICATION & REQUIREMENTS.

ref.	revision	date
P	LOCATION PLAN RED LINE AMENDED - PLANNING	JAN 2024
C	CLIENT AMENDMENTS	DEC 2024
B	CLIENT AMENDMENTS	DEC 2024
A	CLIENT AMENDMENTS	JULY 2024

G. R. MERCHANT LTD.
ARCHITECTURAL CONSULTANTS

4 Wrights Mews
12A Park Road, Holbeach,
Spalding, Lincs. PE12 7EE
Tel: 01406 490800
E-Mail: office@grmerchantltd.com
Website: www.grmerchantltd.com

Project
RESIDENTIAL DEVELOPMENT
AT 47 FLEET STREET
HOLBEACH, SPALDING
Lincs, PE12 7AG..

Client
MR. A. SUKERNO.

Drawing
SITE PLAN - EXISTING & PROPOSED
LOCATION PLAN

Job Ref: 4202-23 Drawing No: 03D

Date: MAY 2024 Drawn: S.D.

Scales
(AS STATED).

DO NOT SCALE FROM THIS DRAWING
This drawing is copyright and may not be altered, copied, photocopied or used for any other purpose other than that for which it is issued. The General Contractor is to check all dimensions on site and report any discrepancies to G. R. Merchant Ltd. All details shown on this drawing including foundations are based upon typical site conditions related to the area. No responsibility can be accepted for abnormal conditions which may be discovered during construction unless reported to the G. R. Merchant Ltd so that design amendments may be considered. Site soil surveys are recommended in all aspects of foundations to establish specific site conditions before foundation work is undertaken. This drawing is limited in the amount of information contained and does not purport to contain a full specification of the work. It is solely for the purpose of obtaining Planning / Building Regulation approval. This drawing must not be used as a contract document alone. The works will not be supervised or inspected on site by G. R. Merchant Ltd or any representative thereof. It is the client or their appointed contractor(s) responsibility to control workmanship, substitution of materials, adherence to specification, variations to contract etc. All materials to be new unless otherwise stated and all components and materials etc. to be used fitted and installed etc. in strict accordance with manufacturers instruction and relevant codes of practice. Materials shall conform to appropriate British standard specification or BBA certificate or European code equivalent. The Employer / Client shall ensure that the selected contractor is competent with and adopts all measures necessary to achieve compliance with Health and Safety legislation for Building sites and Work places. The Employer / Client is advised that should the works need to comply with the Construction Design and Management Regulations an independent Principal Designer will be required. The works shall comprise of all that is shown on the drawing and details. Work that may not specifically be shown but may be reasonably inferred as necessary to carry out the works shall be deemed to be included. It is the job / land owners responsibility to be aware of the Party Wall Act. As 1999, when building in close proximity to adjoining neighbours boundaries.