

PRODUCTION DRAWING

FOR INTERNAL USE ONLY NOT FOR OUTSIDE ISSUE

REVISIONS

CHGE	DESCRIPTION	DRWN	DATE	APPR

LATHAM PANELS.
 1.23 U-VALUE
 14.5mm SAPELE x 2
 3.5mm PLY X 2
 8mm ArmaFORM® PET/W GR: X 1

TIMBMET PANELS.
 1.34 U-VALUE
 15mm SAPELE x 2
 3.5mm PLY X 2
 8mm POLYSTYRENE X 1

PANEL DESIGN CAN BE TO CUTTERS AVAILABLE.
 MUST FINISH 25.5mm BETWEEN BEAD & REBATE

Tremco 2 x 12mm glazing tape TN136
 Silicone cap all round TRANSLUCENT

Tremco 2 x 8mm glazing tape TN136

Tremco SP050 Sealant adhesive

Tremco 1 x 6mm Clear glazing tape TN021 OR BOND WITH SP050

24mm WHITE GLAZING CLIPS

OPTIONAL SWEDISH JOINT.

Deventer Seal SPV-124-18

OPTIONAL SWEDISH JOINT.

OPTIONAL CILL EXTENSIONS.

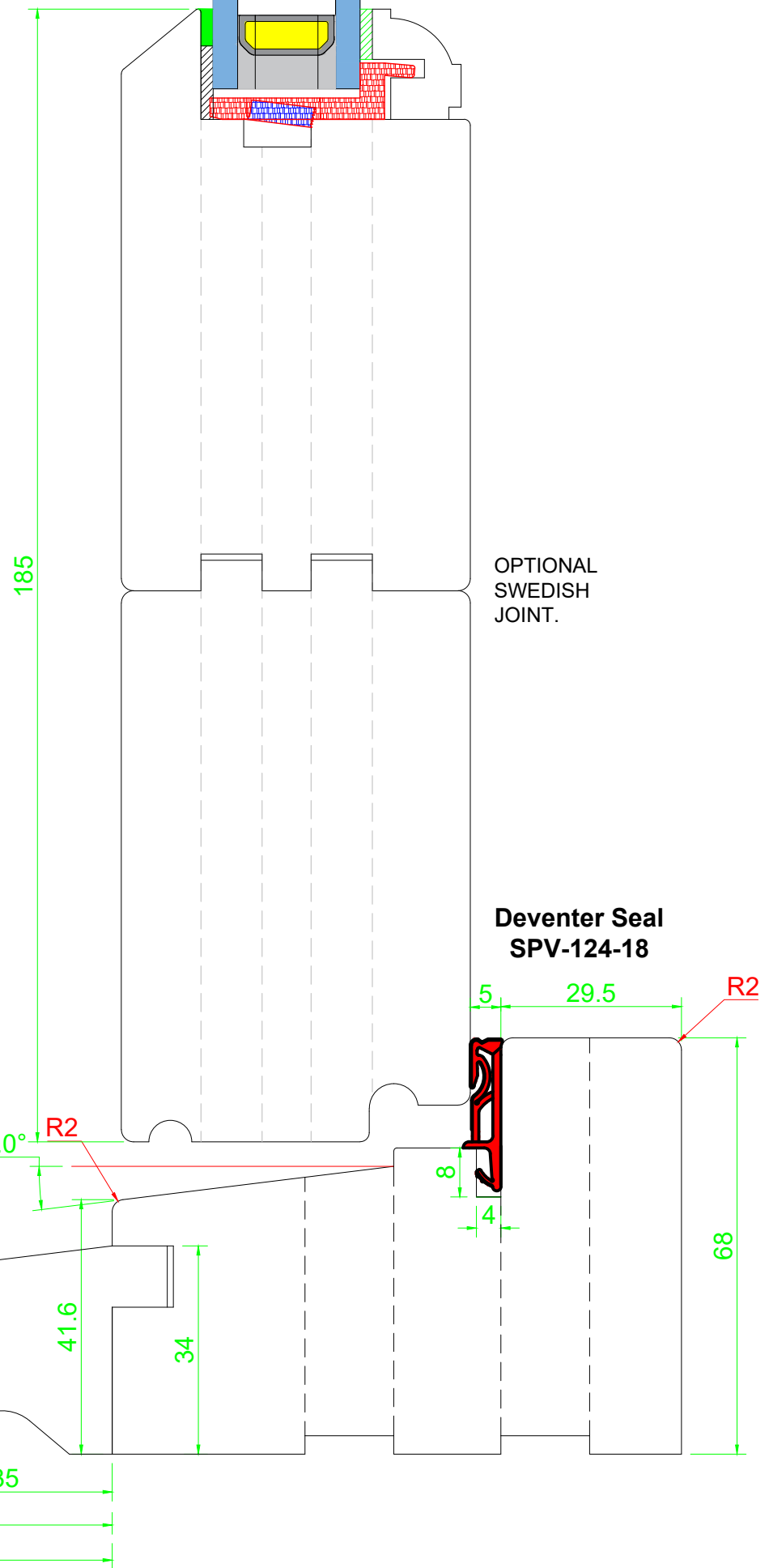
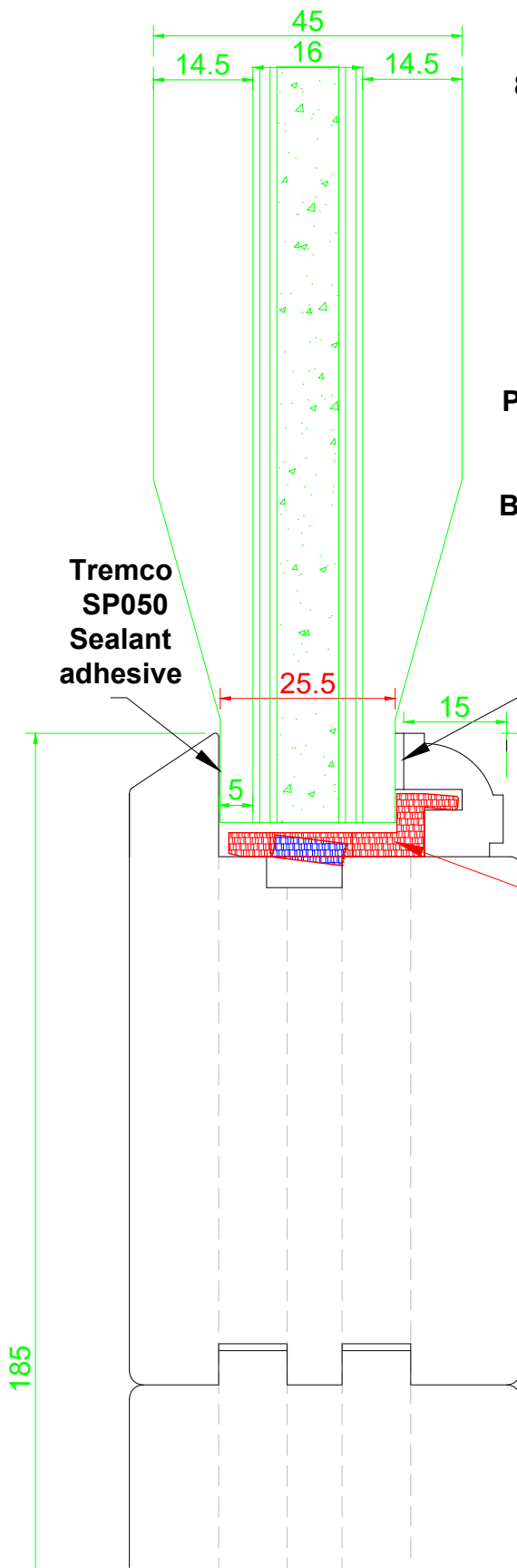

TOLERANCES
 UNLESS OTHERWISE SPECIFIED
 ALL DIMENSIONS IN MM
 ALL LINEAR DIMENSIONS ±0.4
 ALL ANGLE DIMENSIONS ±0.5°
 BREAK ALL SHARP EDGES 0.5



1 ENNERDALE AVENUE
 GREAT NOTLEY
 BRAINTREE
 CM77 7UE
 Tel: 07943 674 886
 EMAIL: owen.dare@yahoo.com
 WEB: www.otdarejoineryconsultants.co.uk

SINGLE DOORS
 24mm GLAZING

TITLE
**HEAD & CILL (PANEL)
 STANDARD OPEN OUT**

SCALE
 1:1

DRAWN BY: OTD
 DATE DRAWN: 24MAR20

DRAWING No:
 OTD-01-09

REV:
E

