

- General Notes
1. All dimensions are shown in 'mm' unless otherwise stated.
  2. The contractor, sub-contractors and suppliers must verify all dimensions on site prior to the commencement of any work.
  3. This drawing is to be read in conjunction with all relevant engineers and specialist sub-contractors drawings and specifications.
  4. Any discrepancies are to be brought to the designers attention.

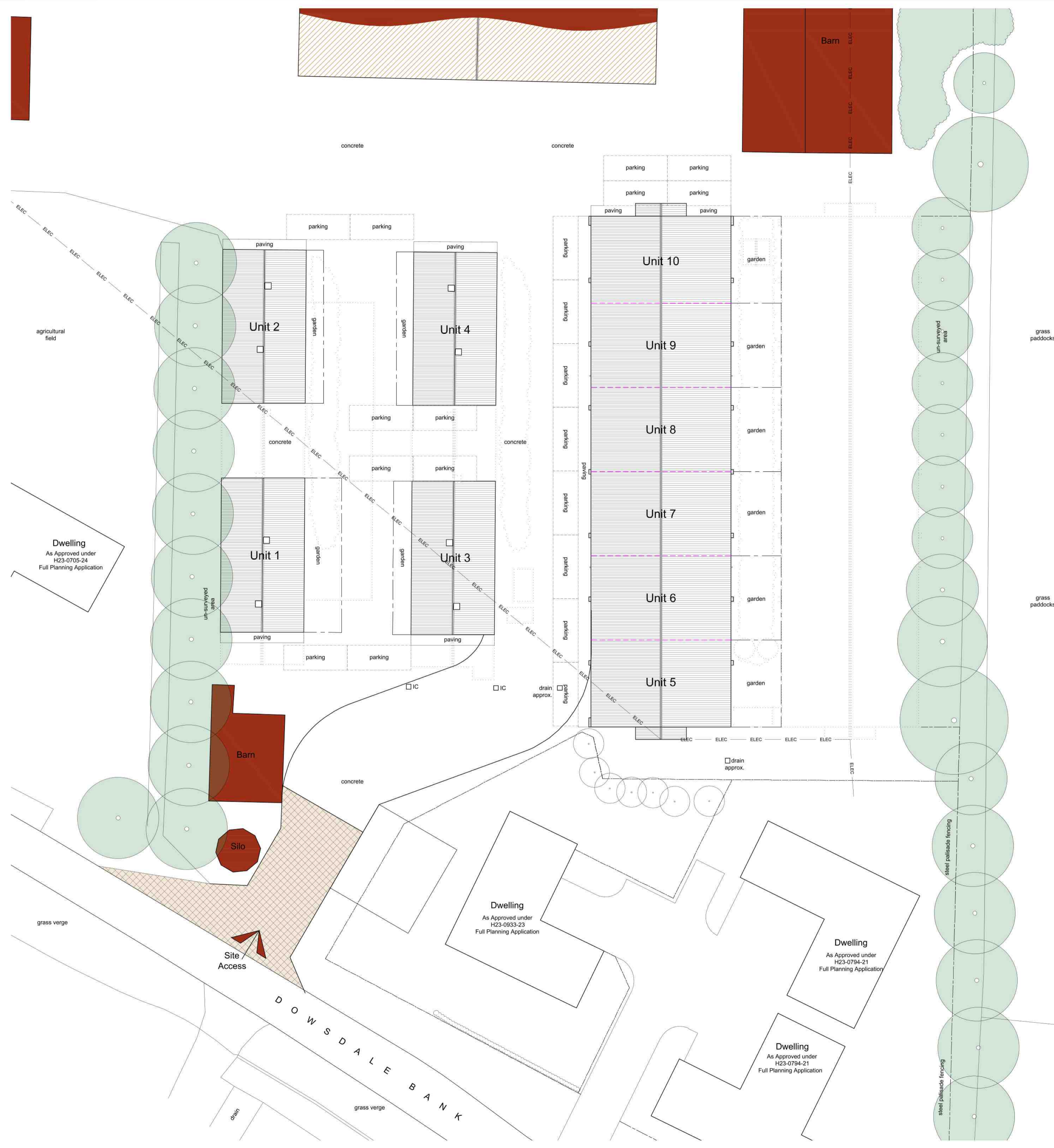

Site Plan  
Scale: 1:200

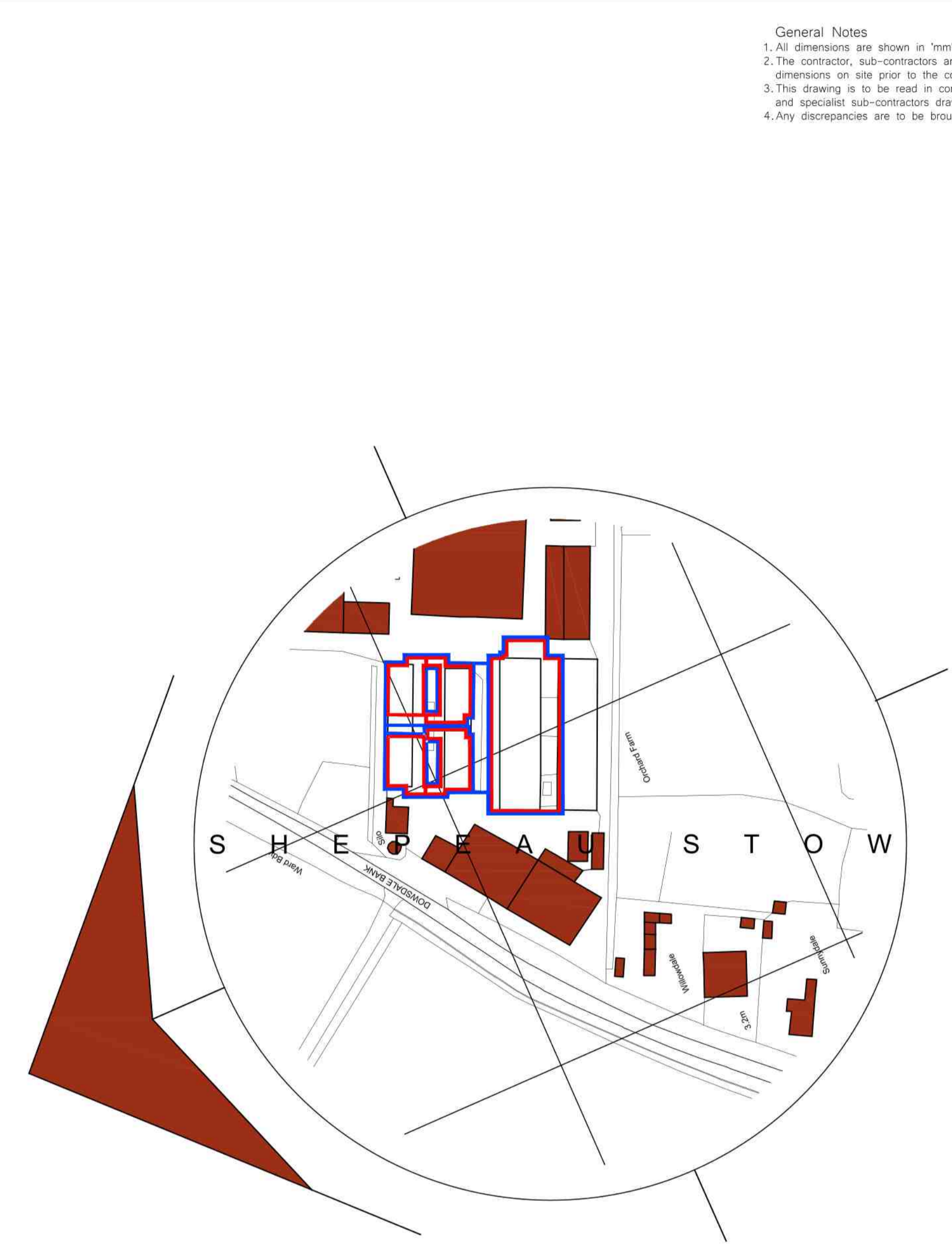

Location Plan  
Scale: 1:1250

SITE KEY

- Indicates buildings for conversion
- Indicates surveyed buildings on site
- Indicates approximate position of un-surveyed buildings taken from OS map
- Indicates approximate position of un-surveyed trees, hedges and overgrowth
- Indicates features to be demolished
- Indicates site access to be utilised and upgraded with hard bound material to comply with county council highways specification

- Site Area - 1925 sqm
- External Building Areas:
- Unit 1 - 118 sqm
- Unit 2 - 117 sqm
- Unit 3 - 117 sqm
- Unit 4 - 117 sqm
- Units 5-10 - 654 sqm

Revisions		
A	April 2025	Revisions following highways comments

FOR APPROVAL

**SWANN EDWARDS**  
ARCHITECTURE

Swann Edwards Architecture Limited, Black Barn, Fan Road, Guyhim, Wisbech, Cambs. PE13 4AA  
t 01945 450694 e info@swannedwards.co.uk w www.swannedwards.co.uk

Job Title Proposed Barn Conversions Orchard Farm, Dowsdale Bank, Shepeau Stow, Spalding For: Mr T Dickens	Date November 2024	Drawn by BR Checked by GE
Drawing Title Planning Drawing Site and Location Plan	Job No. SE-2198	Sheet Size A1
	Dwg No. PP1000	Revision A