

Hither Hold Farm, Further Old Gate  
Screening Assessment Photographs  
31.05.2022



1.  
View of front of grain store as seen from Further Old Gate, showing hardcore access track and vegetation along the road either side.



2.  
View of rear of grain store facing the fields to the north, showing self seeded grass meadow vegetation. Tree cluster visible on the left is on adjacent land. Brick wall forming the west wall of the grain store visible on the right hand side, with brick pier structure on the outside suggesting that any earlier structures faced 'inwards' and were therefore contained within the footprint of the grain store. No other footings, slabs or rubble are present elsewhere on the site.



3.  
View of grain store from the west showing the ground in agricultural use after the winter season.

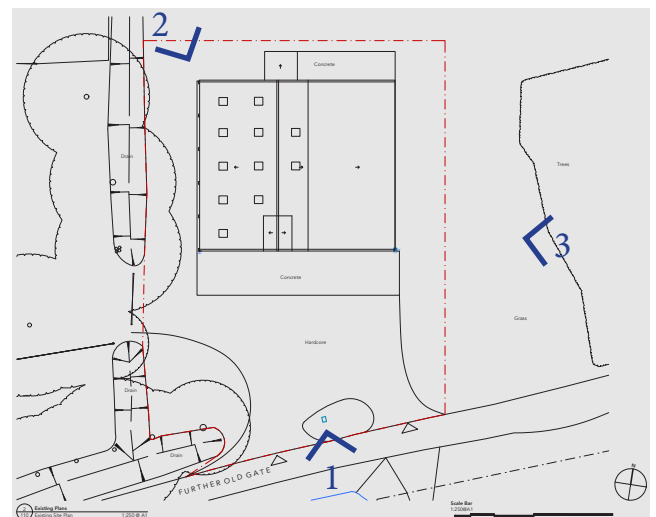



4.  
View to the side of the grain store looking south. Private drain runs along the right hand side, with tree clump on adjacent land to the other side of the drain formed of willow, oak and ash trees. Grassland meadow vegetation typical to the Lincolnshire agricultural lowlands seen in the foreground. Vegetation is consistent throughout the site and surrounding land, and is in good condition with no signs of distress or dieback.



5.  
View of drain running to the west of the site, with meadow grassland verges typical of the area.



6.  
View of fields to the north of the grain store.

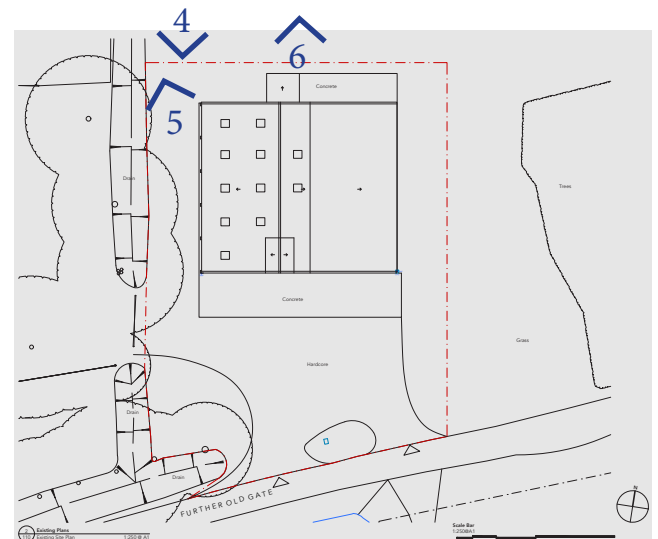



7.  
View of hardstanding to the front of the grain store, showing concrete formed of 4 slabs in good condition and clear of staining or cracks. Adjacent residential property visible beyond.



8.  
Interior of grain store showing structure in good condition, clean and clear of any signs of contamination, spillages or chemical attack.

Hither Hold Farm, Further Old Gate  
Screening Assessment Photographs  
31.05.2022

Matthew McKenna  
Architect  
BArch (Hons) DipArch MArch PGCert ARB

